



The View Innsbruck

Data and facts

Company	STRAUSS PROPERTY MANAGEMENT
Type	Residential construction, Property management

[Project report online](#)

www.porr-group.com



The View - the most attractive view of the city

The property has been managed by STRAUSS PROPERTY MANAGEMENT ever since it was completed and handed over to the owners in 2017. This project's exclusivity and the corresponding level of support required by its owners present a special challenge.

Impressions

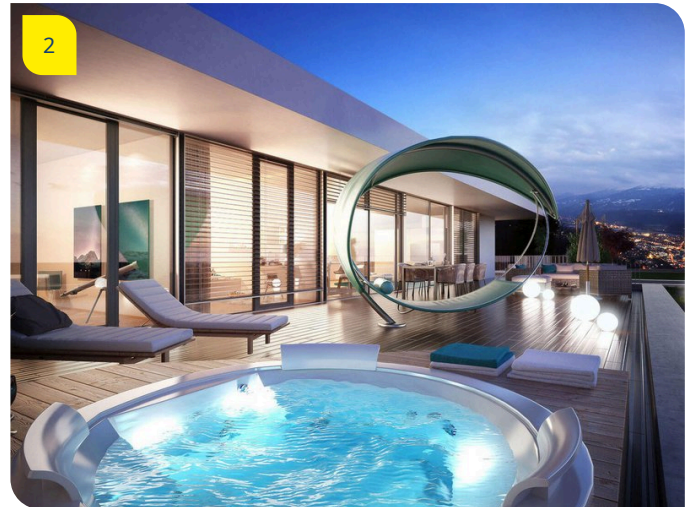

Image notes

1

Attractive mountainside location.

The flat complex The View on the outskirts of Innsbruck appears to have grown naturally out of the mountainside.

2

Unique in every sense of the word.

The name "The View" speaks for itself. It offers exclusive residential units and a unique view of Innsbruck while at the same time preserving residents' privacy.

Do you have questions about the project or would you like to learn more? Feel free to contact us for further information.

PORR AG Group Communications

Absberggasse 47

1100 Wien

T +43 50 626-0

E-Mail: comms@porr-group.com